

FullLand®



DMU-650SR 5 AXIS MACHINING CENTER

Feature 4H+1R

- High Precision
- High Rigidity
- High Performance
- High Speed
- Reliable

Awarded as A Proof of Excellence In Technical



FullLand®

GEON CHENG TECHNOLOGY CO., LTD.
 P.O.BOX 246 FENG YUAN TAICHUNG, TAIWAN
 No.78, Sanshe Rd., Shengang Dist. Taichung City 429, Taiwan
 TEL: +886-4-25316697 FAX: +886-4-25316657
 E-mail Address: geontech@hibox.hinet.net
 www.geontech.com.tw



Mold making / Car industry / 3C industry / Mechanical equipment / Aerospace industry

5 AXIS MACHINING CENTER



1 Machine Bed

- Machine bed and slide systems made of solid welded steel and cast iron components

2 Tool magazine

- Tool changer with 20 (30, 50) ISO30, 30 (50) HSK-A40 tool stations

3 Spindle

- Mechanical spindle direct drive: 12000 rpm
- Water-cooled motor spindle: 24000 rpm

4 Control

- State-of-the-art control technology from Siemens - Siemens 840D sl or Heidenhain - TNC 620/TNC 640

5 Control Panel

- Ergonomically positioned and swivelling control panel

6 Table

- Massive swivel-rotary table with \varnothing 400 mm

7 Chip Removal

- The chips can be removed by an optional available hinge type chip conveyer

TORQUE POWER CHART

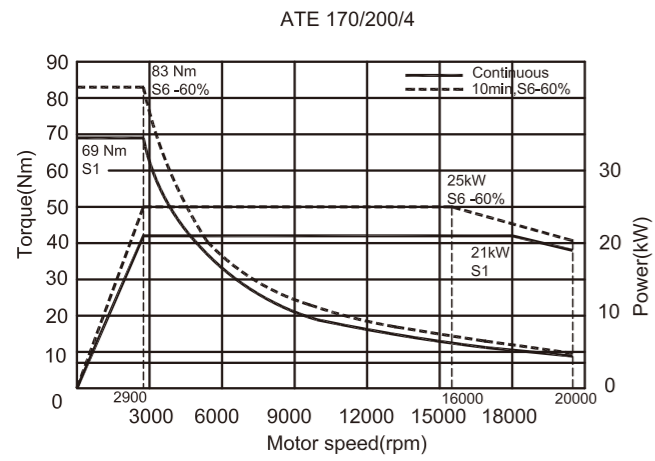

Heidenhain QAN200UH - 12,000 rpm Standard

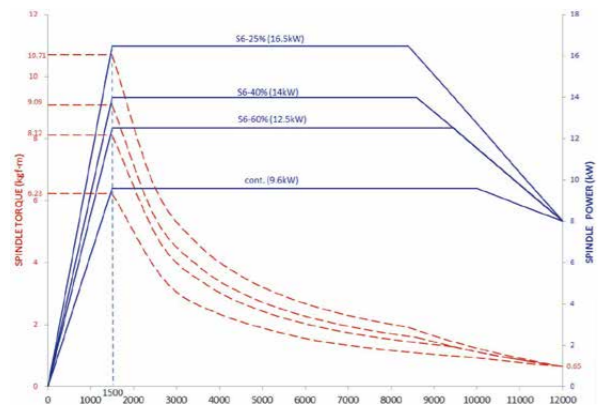

Heidenhain QAN200U - 8,000 rpm Gearbox Option

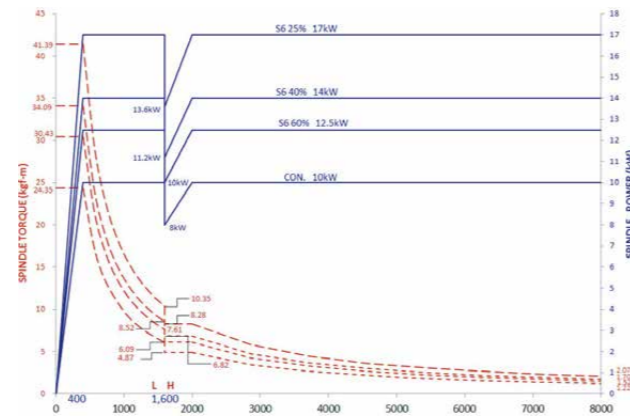

Siemens 1PH8107 - 12,000 rpm Standard

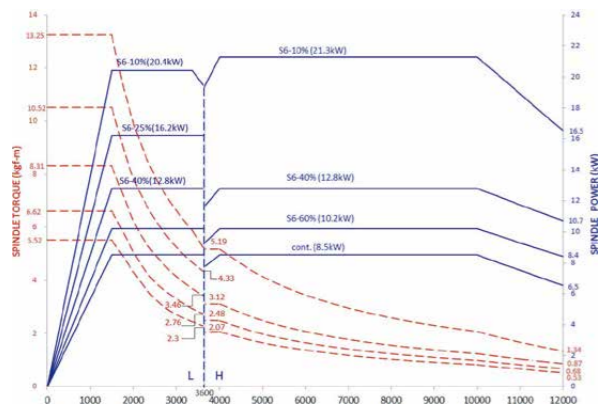

Siemens 1PH8131 - 15,000 rpm Option

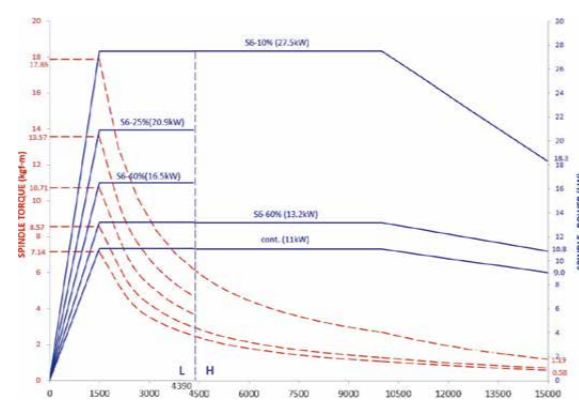

Workpieces



STANDARD ACCESSORIES

- BC axes with encoders
- Heat exchanger
- Remote handwheel
- Central lubrication system
- Full guarding(without top cover)
- High pressure water scour for chip removal
- Chip conveyor
- Coolant gun
- Air gun
- Spindle oil cooler
- LED work light
- Program light 3 colors
- Leveling bolts & plate
- Tools & box

OPTIONAL ACCESSORIES

- CTS30BAR
- CE
- Linear scales
- chain type ATC 40T & 60T
- Air conditioner for electrical box

CUTTING AREA

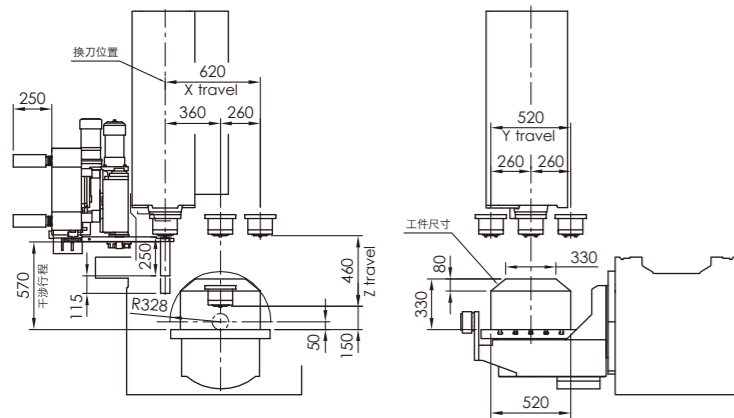

INTERFERE AREA

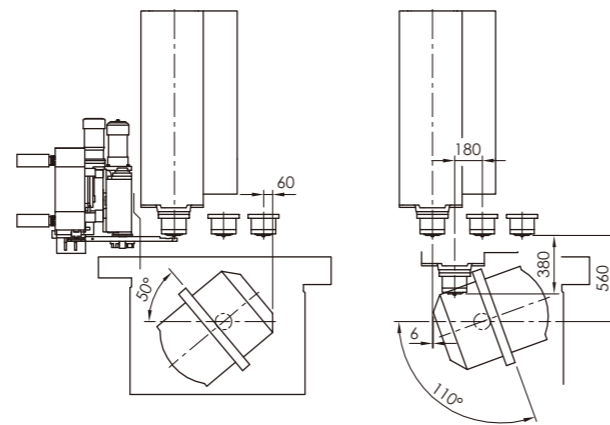

MACHINE DIMENSION

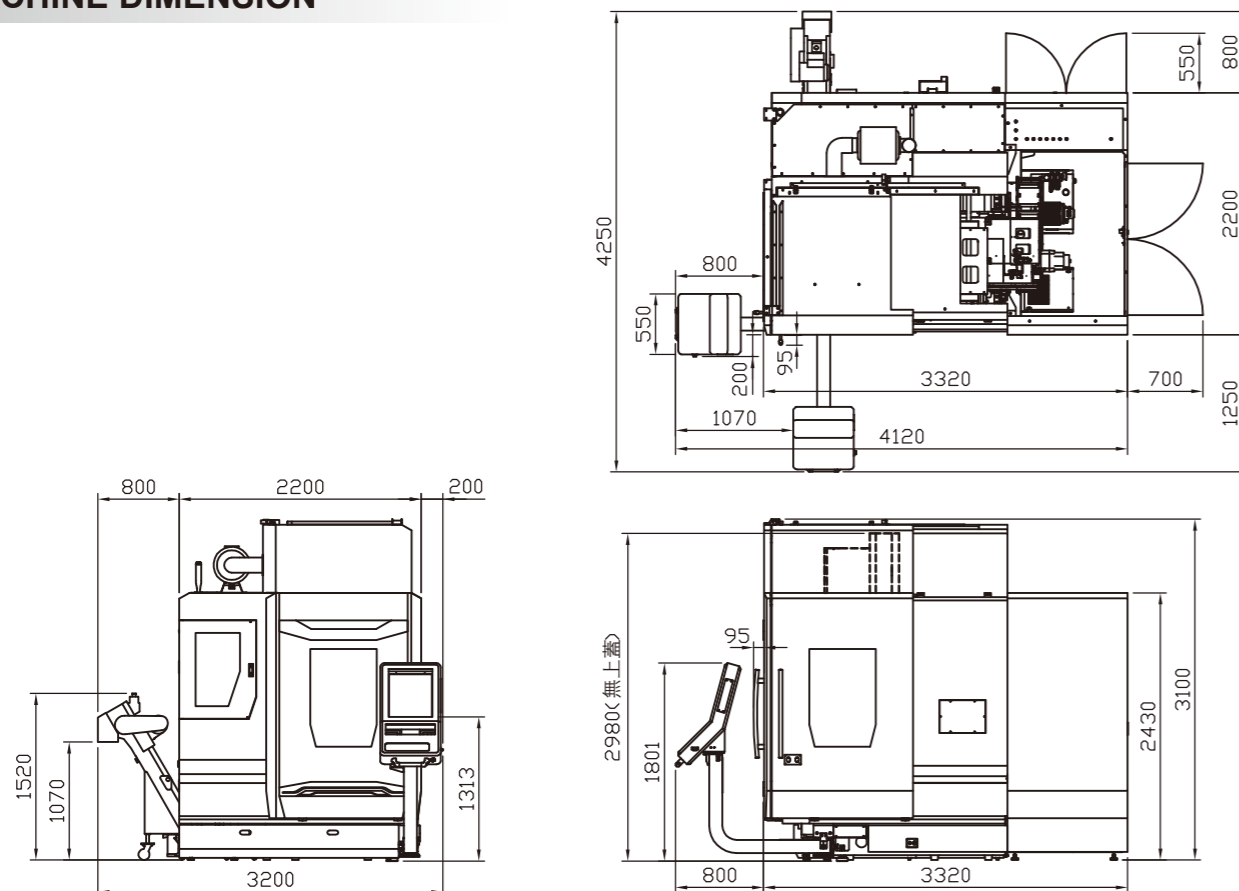

SPECIFICATION

		DMU-650SR	DMU-500SR
X/Y/Z travel	mm	620/520/460 (24.4"/20.4"/18.1")	550/400/350 (21.6"/15.7"/13.7")
3 axis slide ways		Linear guide (roller type)	
Table size	mm	ø650 (25.5")	ø500 (19.6")
Spindle center to column surface	mm	150~610 (5.9"~24")	150~500 (5.9"~19.6")
B axis swiveling range	deg	-50°~+110°	
C axis rotary range	deg	360°	
Table load capacity (Horizontal)	lbs	661	
Table load capacity (Tilting)	lbs	441	
Rapid feed rate (X/Y/Z)	m/min	36/36/36	
T slot (Q'ty×size×Dist)		5×18×100	
Cutting feed rate	m/min	1~15000mm	
ATC storage capacity		32T	
Max. tool size (Full)	Mm	Ø75 (2.9")	
Max. tool size (Next empty)	Mm	Ø125 (4.9")	
Max. tool length	mm	250 (9.8")	
Max. tool weight	lbs	15	
Spindle taper		BBT40	
Spindle speed	rpm	12000 (opt 15000, 24000)	
Spindle motor	kw	10 / 12.5	
Spindle transmission		Direct type (opt Build-in)	
Machine dimensions (approx.)	mm	2500x2700x3000 (98.4"x106.2"x118.1")	2350/2500/2800 (92.5"x98.4"x110")
Machine net weight (approx.)	kg	8200	7000

The manufacturer reserves the right to modify the design, specifications, mechanisms, etc. to improve the performance of the machine. Specifications are subject to change without notice.